

FOR LEASE

# WILMINGTON COMMERCE PARK BUILDING 9

WILMINGTON, OHIO

## FEATURES:

- Entire structure is painted inside and out
- 6" floor slabs
- Quality landscaping
- Plenty of parking



## LOCATION MAP

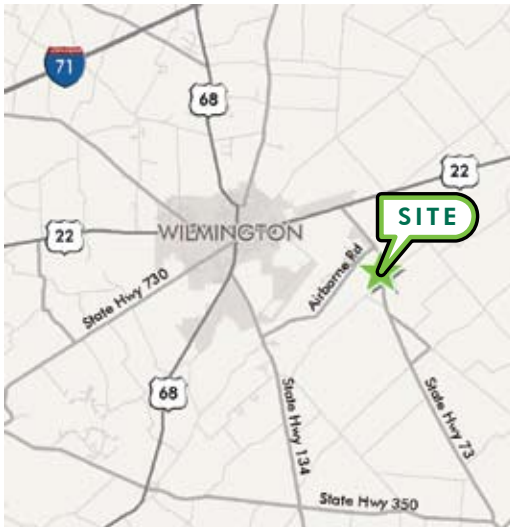

Total Space:	102,400 SF +/-
Office Area:	4,500 SF +/-
Ceiling Height:	24'
Loading Facilities:	14 dock doors (9' x 9') 2 drive-in doors (12' x 14')
Year Built:	2000
Zoning:	Industrial
Warehouse Floor:	6" floor slabs
Construction:	Tilt-up concrete and steel
Insulation:	R12 roof and walls
Parking:	Ample
Sprinkler:	ESFR system
Heating:	Gas-forced unit heaters
Electrical:	277/480 volt, 1,500 amp, 3 phase
Lease Rate:	\$3.00/SF Net

FOR MORE  
INFORMATION  
PLEASE  
CONTACT

**Jeffrey Bennett**

Broker/Owner

937.382.4427

jeffreymbennett@yahoo.com



**Ed Schreyer**

Senior Vice President

513.369.1331

ed.schreyer@cbre.com

**CBRE**  
CB RICHARD ELLIS

FOR LEASE



# WILMINGTON COMMERCE PARK BUILDING 9

WILMINGTON, OHIO

## FLOOR PLAN

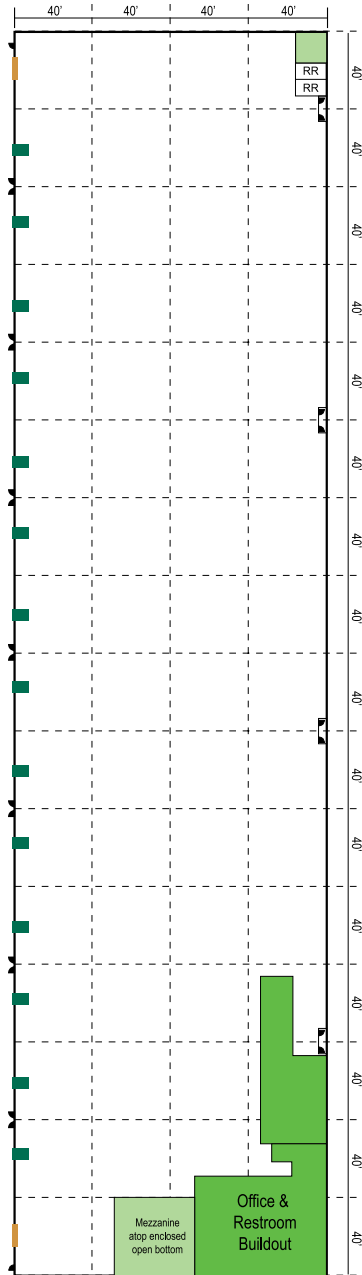

FOR MORE  
INFORMATION  
PLEASE  
CONTACT

### Jeffrey Bennett

Broker/Owner

937.382.4427

jeffreymbennett@yahoo.com



### Ed Schreyer

Senior Vice President

513.369.1331

ed.schreyer@cbre.com



CB Richard Ellis | 201 E. Fifth Street | Suite 1200 | Cincinnati, OH 45202 | [www.cbre.com/cincinnati](http://www.cbre.com/cincinnati)

©2009 CB Richard Ellis, Inc. The information above has been obtained from sources believed reliable. While we do not doubt its accuracy, we have not verified it and make no guarantee, warranty or representation about it. It is your responsibility to independently confirm its accuracy and completeness.